



# OPERATION AND MAINTENANCE MANUAL

## Kolumna

Touch / Button



- 
- 
1. **INTRODUCTION**
  2. **UNPACKING**
    - 2.1 Box Content
    - 2.2 Description of the appliance
  3. **INSTALLING THE UNIT**
    - 3.1 Stand-alone installation
    - 3.2 How to fix the Kolumna directly to a counter
  4. **FIRST POWER-ON**
    - 4.1 Turn on the tablet
    - 4.2 Connect the machine to the internet
    - 4.3 Launch Zerica app
  5. **BASIC SETTINGS TABLET (TOUCH MODEL ONLY)**
    - 5.1 Entering the settings area
    - 5.2 Settings
    - 5.3 Cold Drinks
    - 5.4 Schedule
    - 5.5 Pricing
    - 5.6 Alerts
    - 5.7 Technical
    - 5.8 Install
    - 5.9 Exiting the settings area
  6. **MAINTENANCE**
    - 6.1 Main maintenance tasks
    - 6.2 On-screen monitoring and warning messages (touch model only)
  7. **DEMOLITION AND DISMANTLING**
  8. **WARRANTY**
  9. **EC DECLARATION OF CONFORMITY**
  10. **DECLARATION DM 174/2004**

Thank you for choosing a Zerica® water dispenser.  
Using the appliance is simple, however before connecting, operating or  
modifying settings on the unit, please read this manual completely.



# 1. INTRODUCTION

LABELS



General warnings



IOT enabled functionality



Notes and explanations



**ATTENTION:** For the correct use of this appliance, we recommend that you carefully read these instructions and that you keep them for future reference.

This manual is an integral part of the appliance and must accompany the product even if it is transferred or sold after first installation.

These instructions are intended to provide information regarding correct installation and operation.

Its disclosure to all interested parties is a prerequisite for correct operation and protection from possible accidents and damage to the appliance and injury to third parties.

The presence of such warnings does not imply that the manufacturer assumes any liability for any damage to property or injury to third parties caused by the use of the device, which has all the original certifications required in order to make it suitable for the use for which it has been designed, as well as safe to use in compliance with applicable standards.

The reproduction of the contents of this manual for distribution to third parties is strictly forbidden without the express prior consent of the manufacturer Zerica S.r.l.

## AVVERTENZE GENERALI

- This appliance is not intended for use by persons (including children) with reduced physical, sensory or mental capabilities, or lack of experience and knowledge, unless they have been given supervision or instructions concerning the use of the appliance by a person responsible for their safety.
- Children must be supervised to assure that they do not play with the machine.
- The appliance must not be installed near water sprays.
- The appliance must not be cleaned with water sprays.
- The appliance needs to be installed on a flat surface.
- Do not install this unit in environments with temperatures lower than +3 °C as internal freezing of the water inside the product will permanently damage the water circuit.
- This appliance generates a noise level below 70 dB.



**ATTENTION:** The installation and maintenance of the appliance must be carried out by professionally qualified personnel, in compliance with the standards and regulations in force, since incorrect installation can cause damage to people, animals and things for which the manufacturer cannot be held responsible.



**ATTENTION:** The data and characteristics indicated in this manual do not bind the manufacturing company, which reserves the right to make all the modifications it deems appropriate, without the obligation of warning or replacement.



**ATTENTION:** Keep this booklet for future reference.



# 2. UNPACKING

- Place the appliance in the upright position which can be easily identified by the direction mark "UP" on the box;
- Open the package and check that there are no dents or obvious damages to the appliance caused by transportation;
- In case of obvious defects or dents, do not install the appliance.

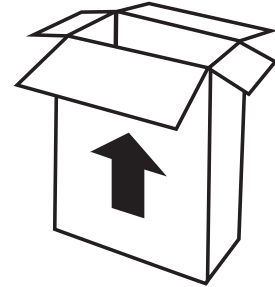

 **Note:** Any defects must be notified within 24 hours of delivery.

## 2.1 BOX CONTENT

#	Qty	Item	Cod.
1	1	Kolumna touch / button	COLOE 0201 / 0101
2	1	Drip tray	RACOGO023
3	1	Intermediate base plate 3mm	SL COLOE 10 03
4	1	Base plate 8mm	SL COLOE 10 02
5	1	Power supply	ALIM006
6	4	Washer Ømm 6.5	RONDP102
7	4	Screw mm 20	VIT12107
8	4	Screw mm 60	VIT12105
9	4	Adhesive rubber foot	PIEDN 010

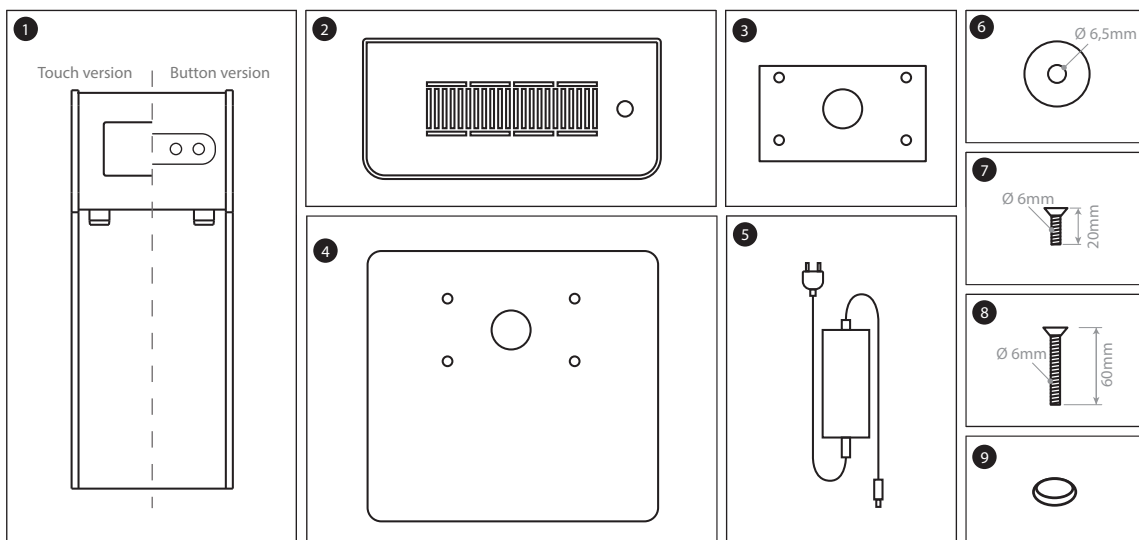

The packaging must be disposed of by the customer in accordance with current environmental protection regulations.

## 2.2 DESCRIPTION OF THE APPLIANCE

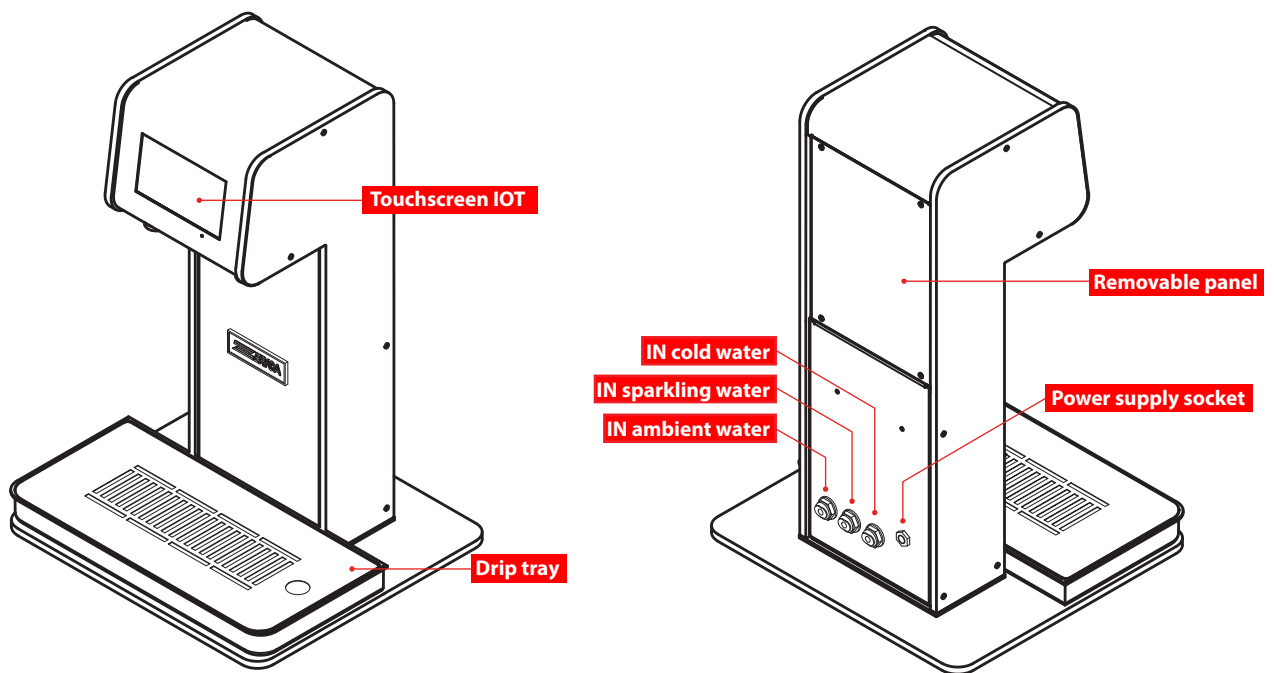

### Device Identification

The identification plate is located on the rear of the system, and it includes the following technical details:

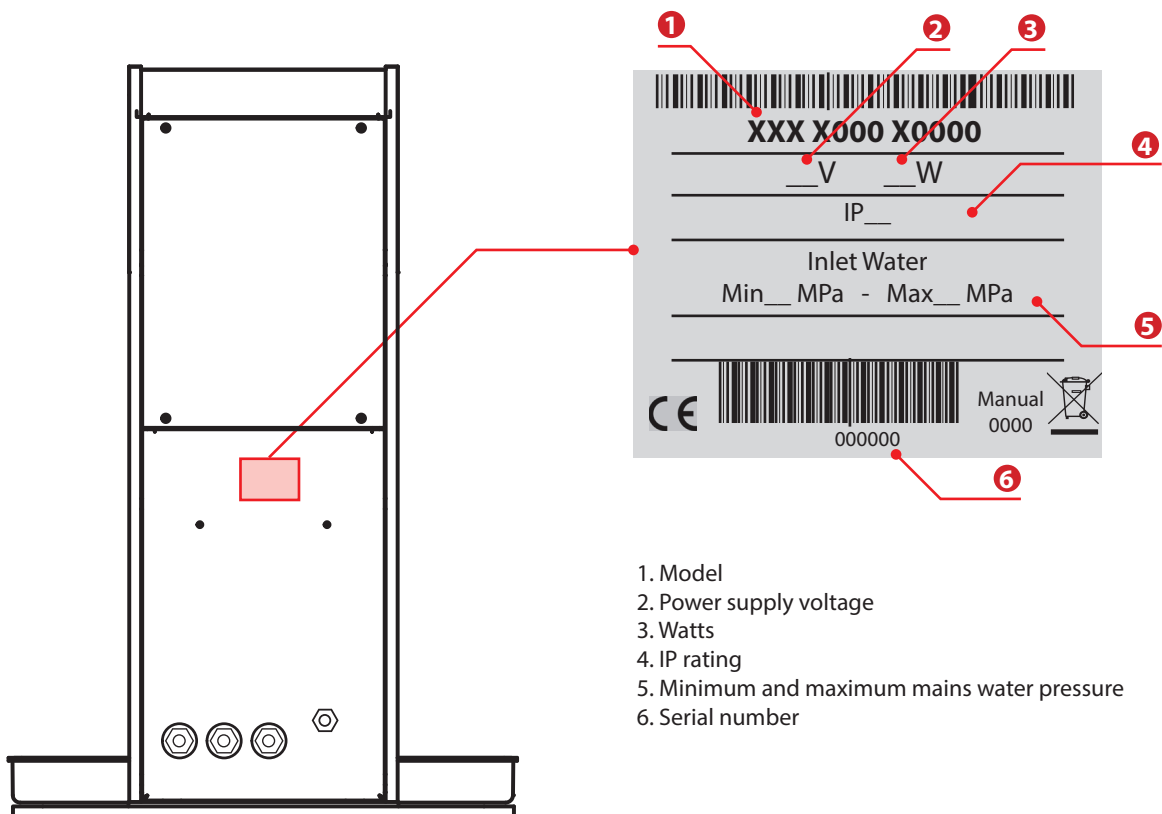

# 3.

## INSTALLING THE UNIT



**ATTENTION:** The installation and maintenance of the appliance must be carried out only by authorised, professionally qualified and trained personnel, and after having disconnected the power supply.

### 3.1 STAND-ALONE INSTALLATION

- Interpose the additional intermediate base plate (2), between the unit and the base plate (3), as shown in the picture, and connect the three parts using the screws (1).
- Stick the adhesive rubber feet (4) at the corners of the base plate.

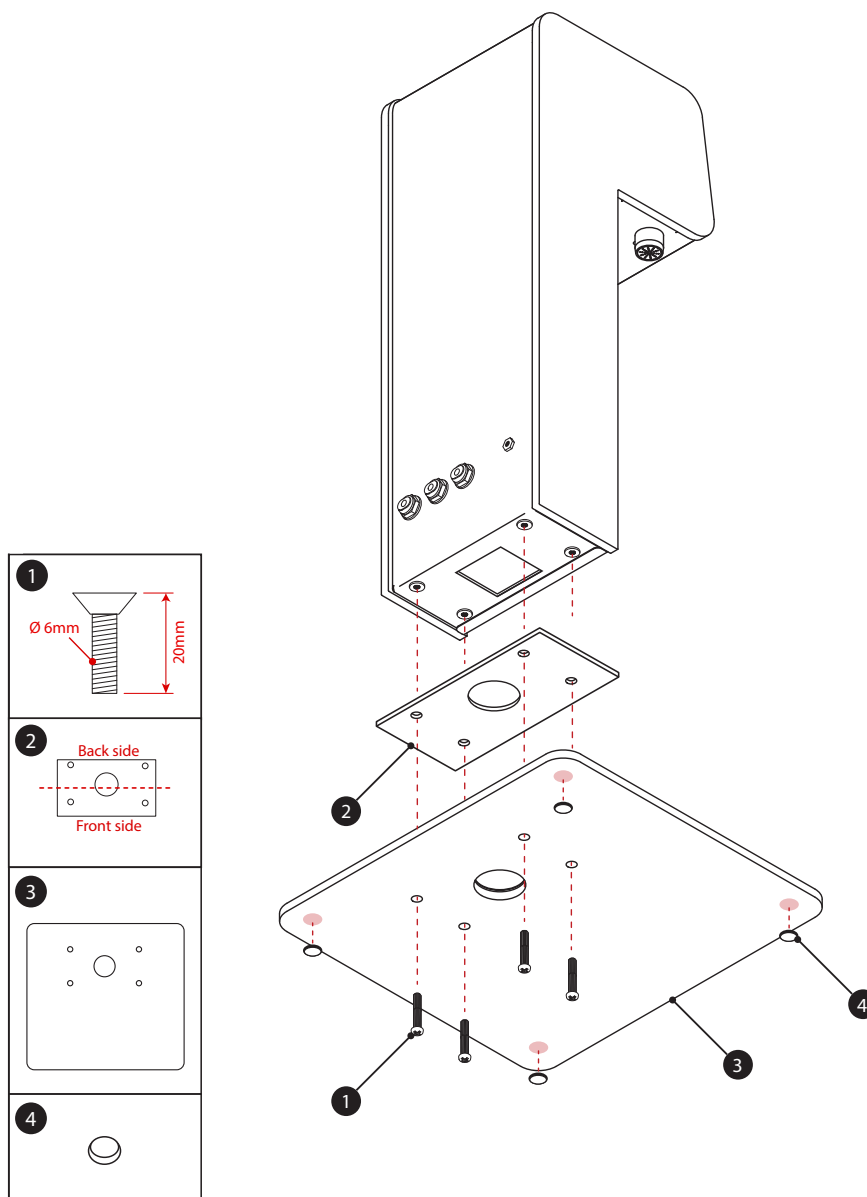



- Place the Kolumna on a flat surface and connect the water supply lines as shown in the picture.
- Connect the unit to the power supply.

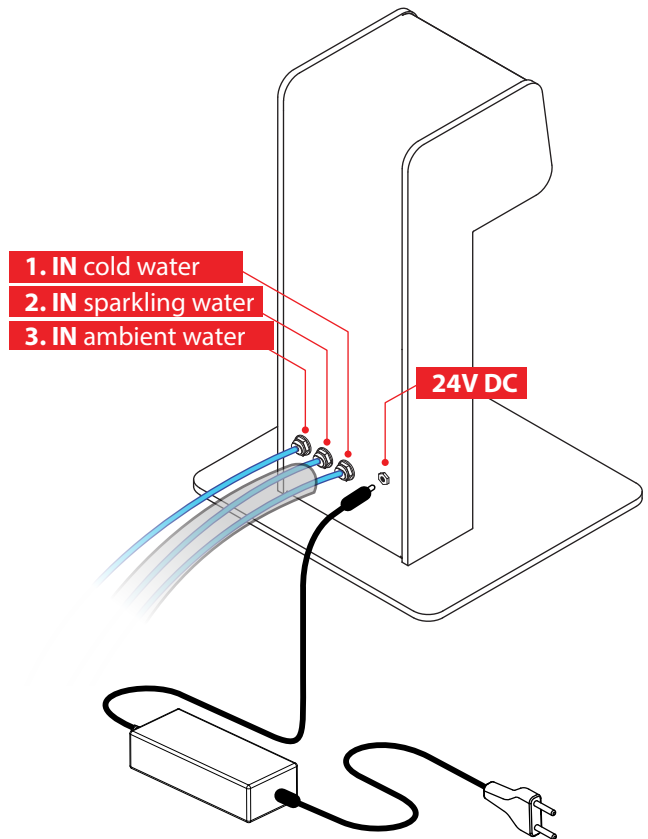

### 3.2 HOW TO FIX THE KOLUMNA DIRECTLY TO A COUNTER

In order to fix the Kolumna to a counter, you will need to drill holes into the counter to allow passage of cables and pipes, and for the fixing screws.

Follow these steps:

1. Place the plexiglass base plate in the desired position.
2. Use the base plate as a guide to mark the points to be drilled on the work surface.
3. Remove the plexiglass base plate.
4. Drill the holes with a drill or similar appropriate tool.

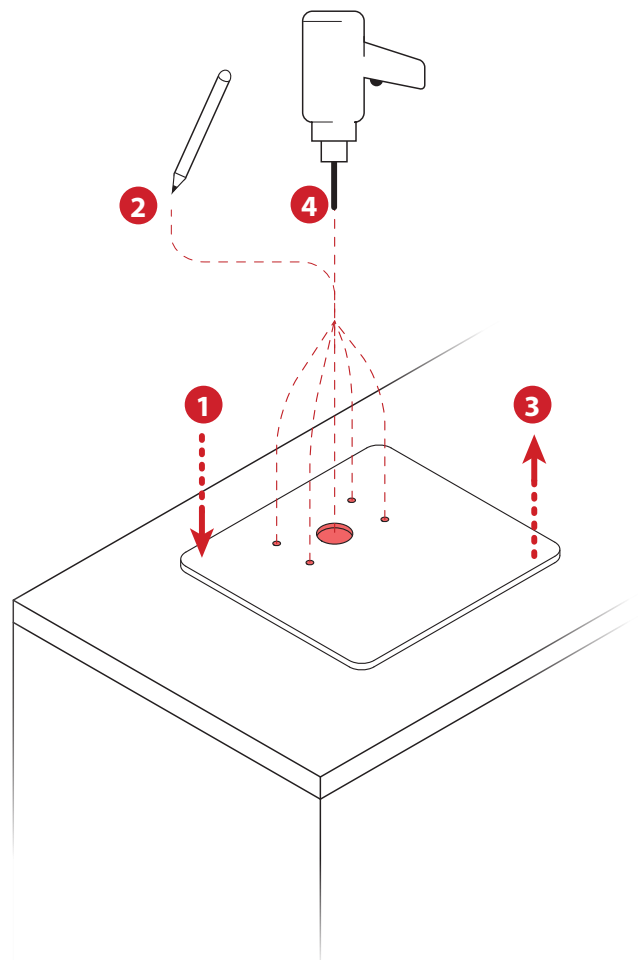

5. Remove the right panel by unscrewing the five access screws.
6. Disconnect the water connections from the back panel and the power supply and pass them through the square hole on the right side of the machine.
7. Connect the pipes to the extensions with the appropriate fittings (not supplied with the Kolumna).

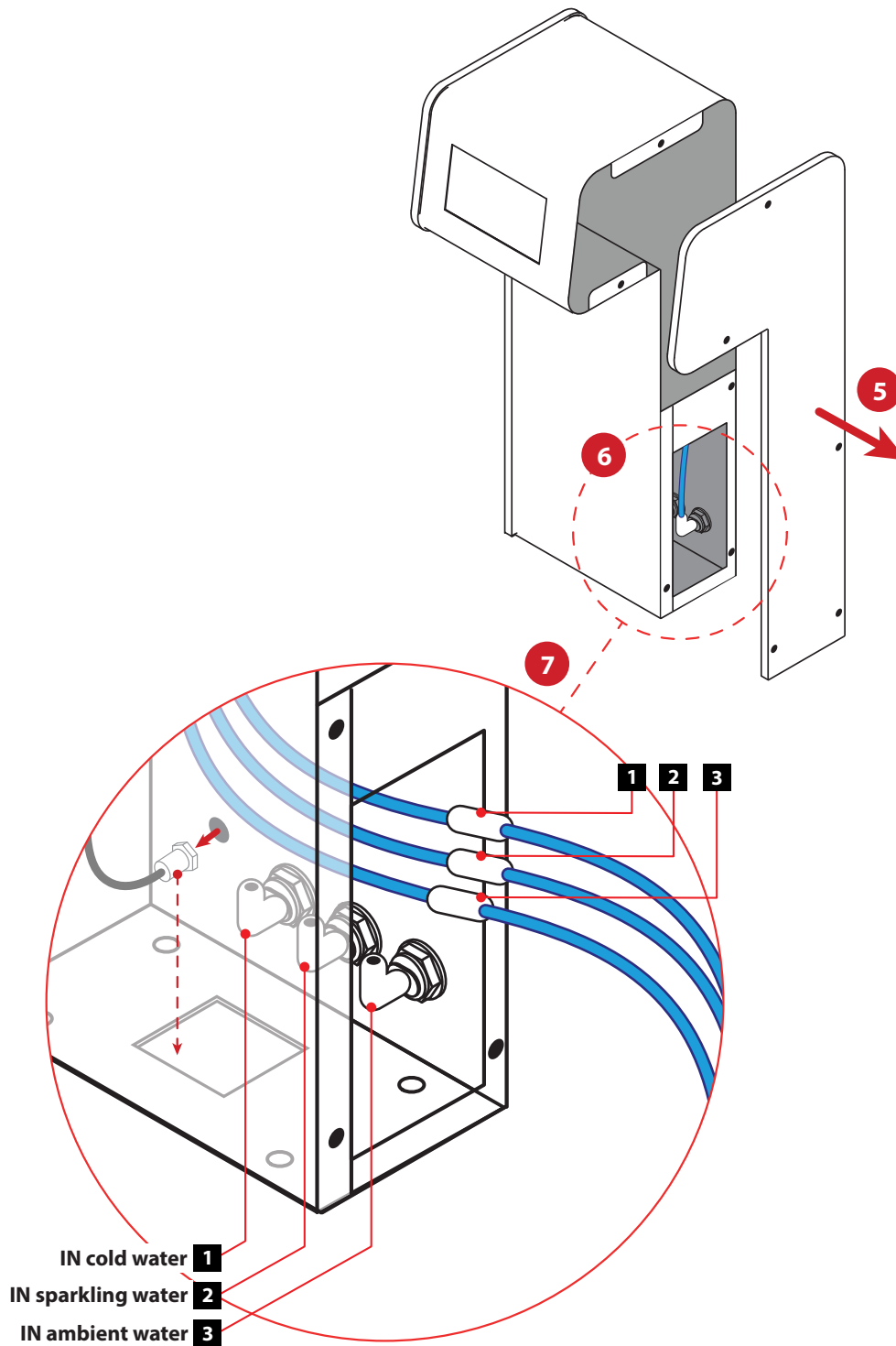

- 8.** Interpose the additional intermediate base plate **(3)** (as shown in the picture) between the counter and Kolumna.
- 9.** Pass the water pipes and the power supply cable through the central hole.
- 10.** Fix the Kolumna to the pre-drilled worktop using the screws **(2)** and washers **(1)** provided.

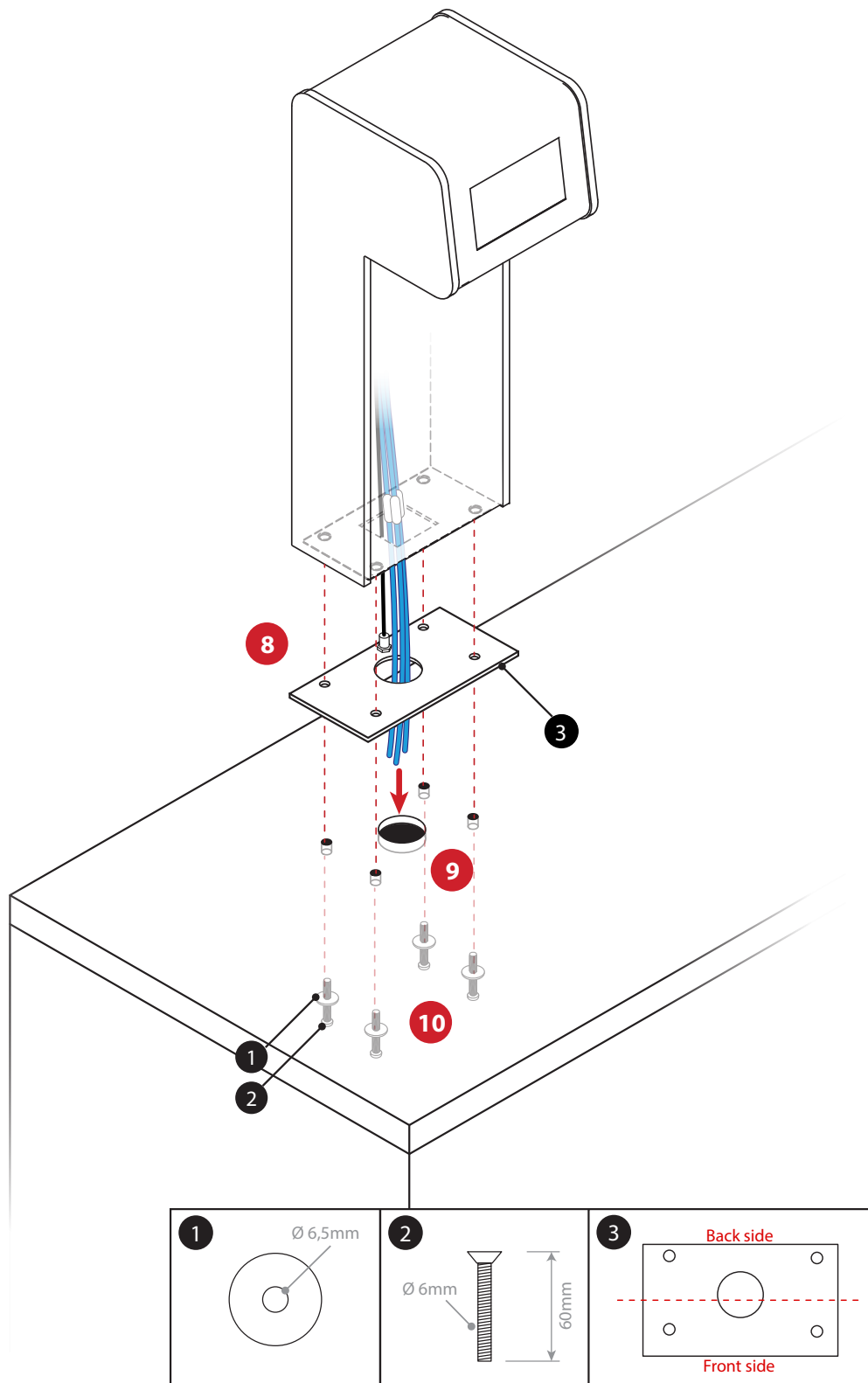

11. Complete the installation by correctly coupling the Kolumna water inlet pipes to the respective outlet pipes of the refrigeration system.
12. Connect the power supply.

**The Kolumna is now ready to be used.**

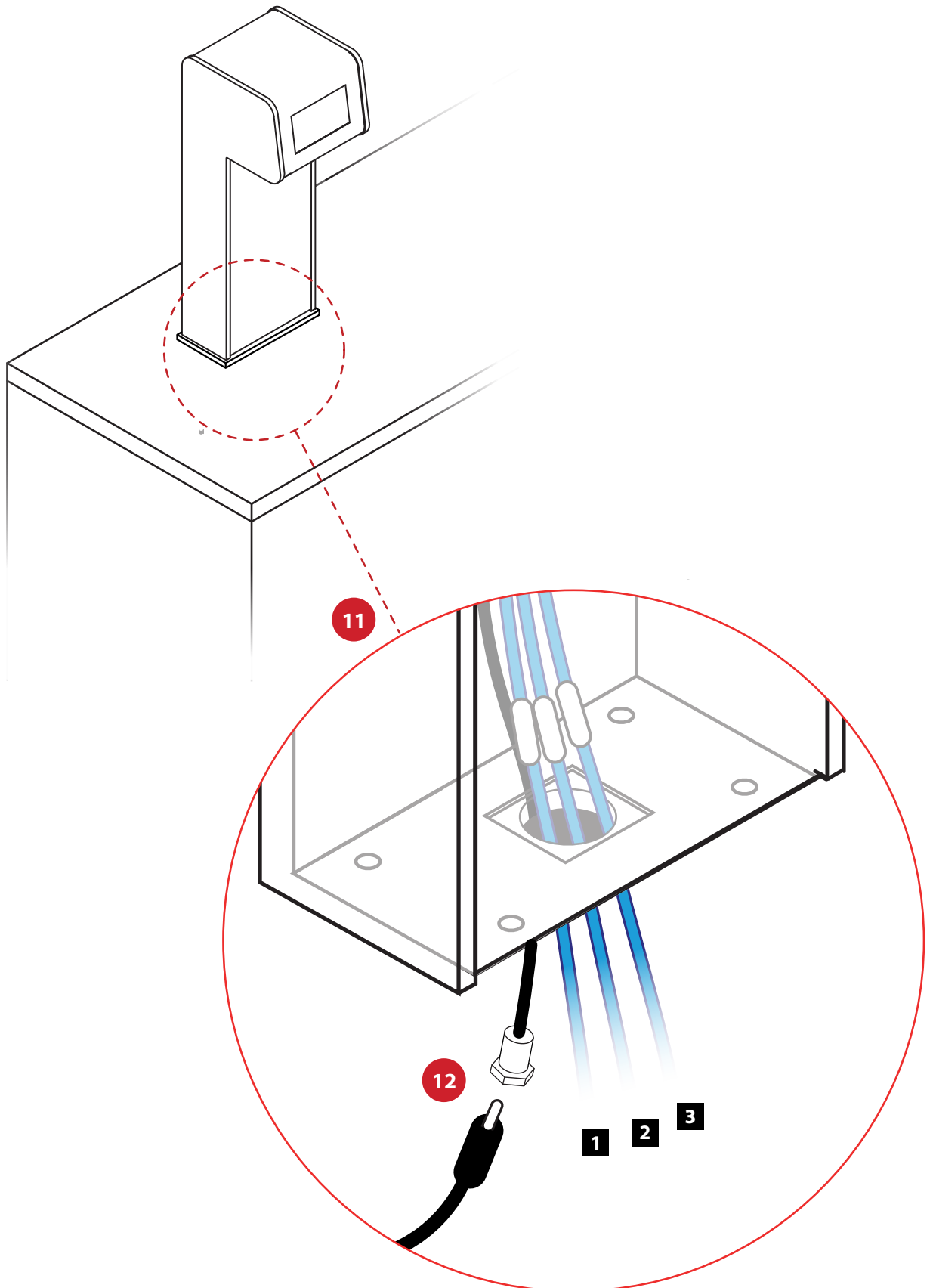

# 4.

## FIRST POWER-ON

### 4.1 TURN ON THE TABLET

- 1 Connect the power supply (A) to the mains.
- 2 Press button (B) (on the "P" version of the unit) until the screen turns on.
- 3 In versions of the unit with a little hole at the front, please use the pin provided (D) into the hole as shown in the drawing (C). Press down until you perceive a slight "click" and keep pressing until the screen turns on.

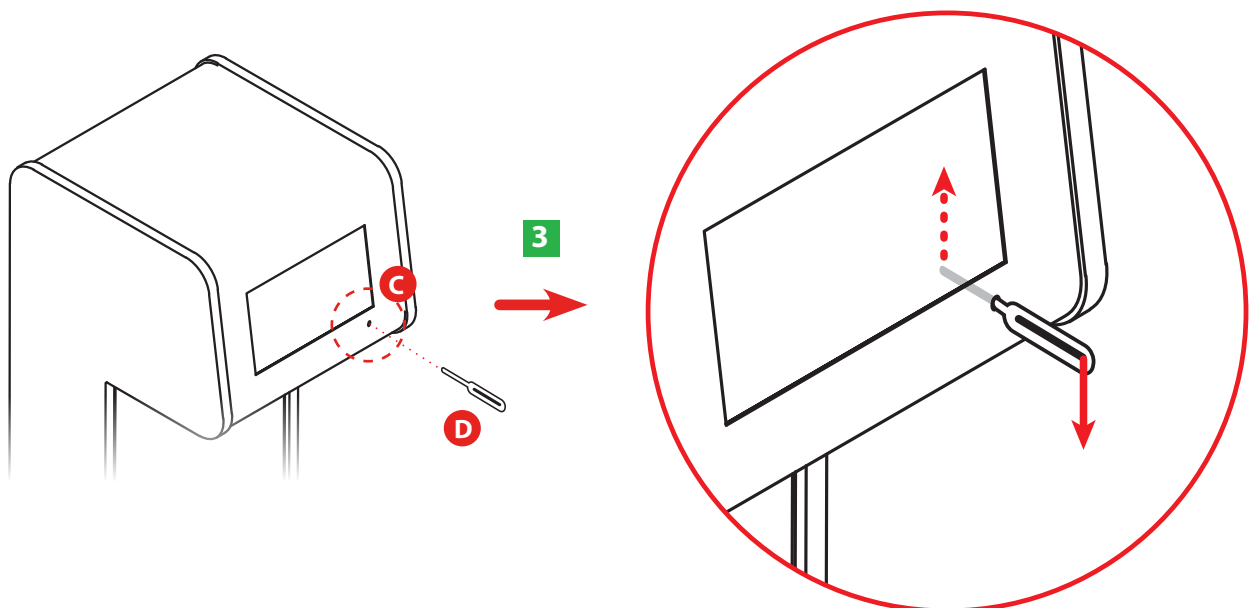
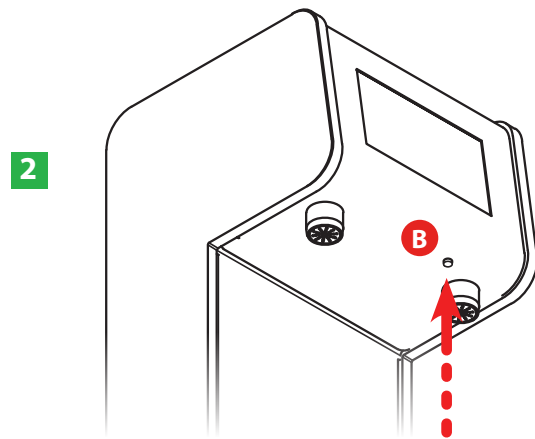
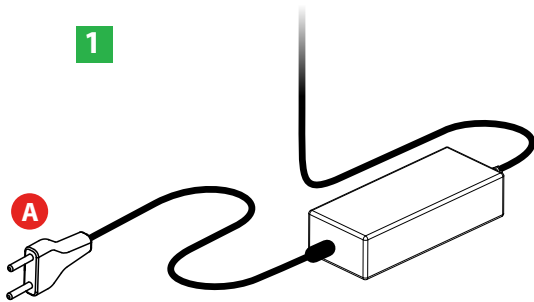

## 4.2 CONNECT THE MACHINE TO THE INTERNET



The unit can work without connection to the internet. However certain operations such as modifying the day schedule (e.g. Normal, Locked or Sleep / Energy Saving modes) can only be performed via the internet.



**Note:** This functionality can be enabled if the system is connected to the internet (via 4G SIM or Wi-Fi). All WEB features are available through a subscription plan. Our sales office is at your disposal for further information.

This unit can be connected to the internet via Mobile network or Wi-Fi network. Our sales department is at your disposal for more information on how to install your SIM or for the purchase of a new SIM.

If you are using Wi-Fi, connect the tablet to a local Wi-Fi using the tablet's standard Settings. Wi-Fi connectivity can be also set-up later from within the app.

## 4.3 LAUNCH ZERICA APP



The Zerica app should launch automatically after a few seconds, but it can be also launched directly from the tablet's Home screen. Launch the Zerica/BeviLaNatura app.

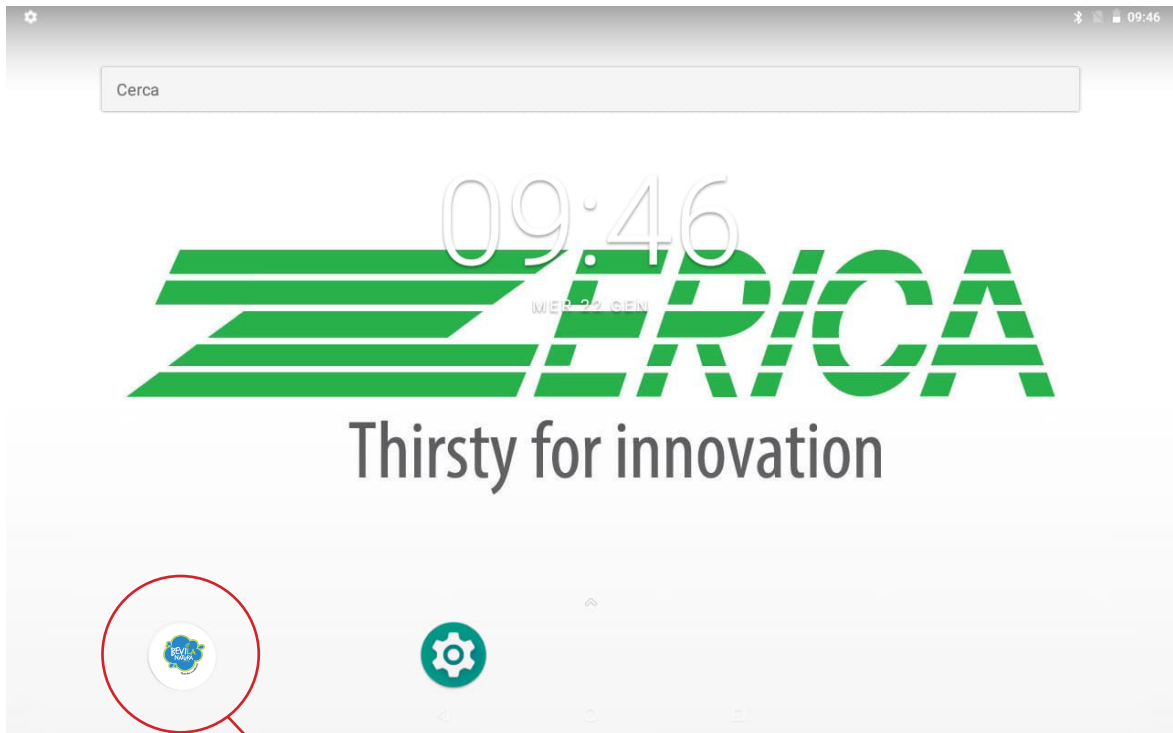

Click on the icon to launch the app.

# 5.

## BASIC SETTINGS TABLET (TOUCH MODEL ONLY)

### 5.1 ENTERING THE SETTINGS AREA

1 Tap on the ZERICA logo on top of the screen (A) to display the monitoring area (B).

 **Note:** The monitoring area shows the estimated remaining filter life (lowest % left of remaining days or remaining litres) if present (C), the percentage of residual capacity of the CO<sub>2</sub> cylinder (if present) (D), the notifications dialog (E), the settings icon (F).

2 Touch the settings icon (F).

3 Enter the password. There are three passwords with increasing level of permissions:

- **775533** - day-to-day operations only, including CO<sub>2</sub> reset and CO<sub>2</sub> purge.
- **123666** - ability to change temperature, dispensing portion size, and to reset filter life.

 **Note:** There is a third password reserved to technicians and installers. Please contact ZERICA's technical support to obtain this password.

4 To exit the "Settings" area, see the next section.

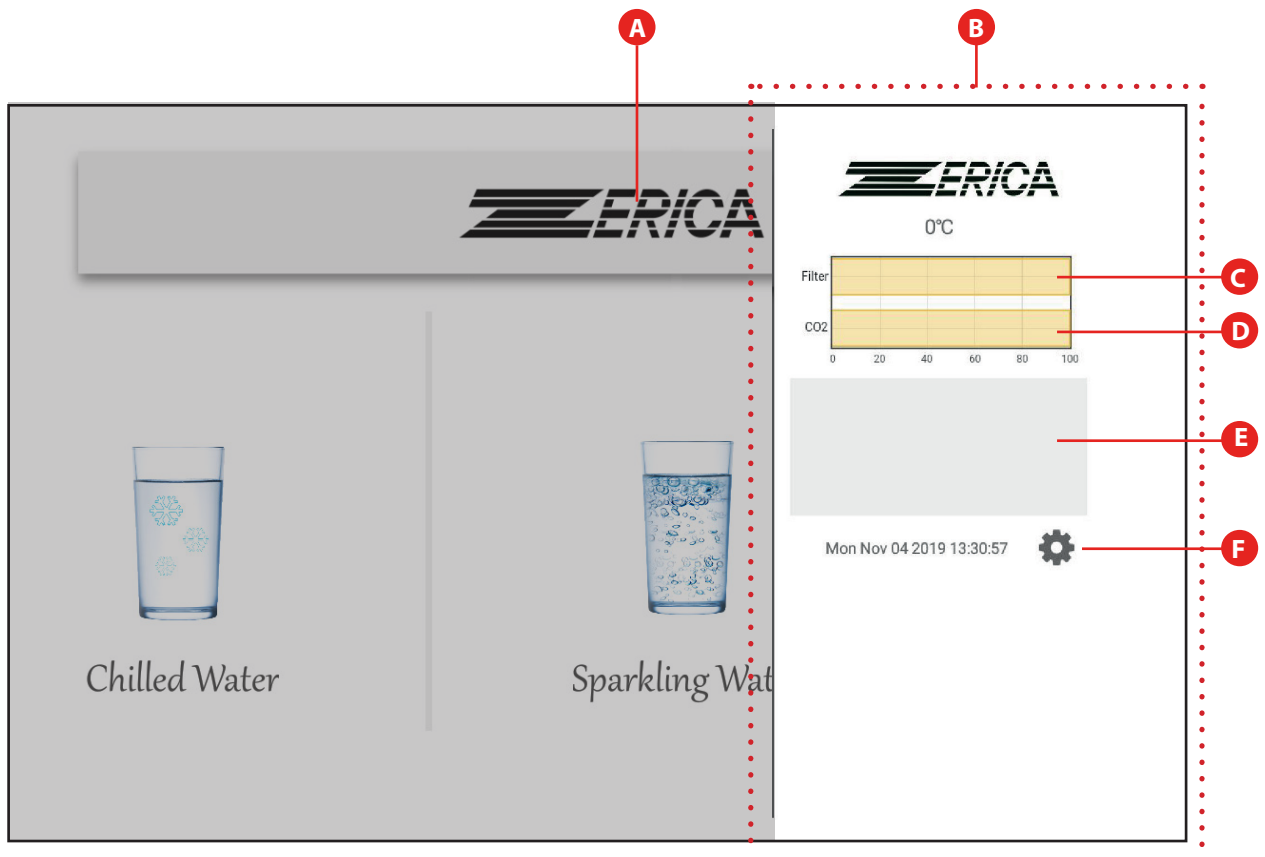

## 5.2 SETTINGS

On this screen you can:

- Disable / enable a specific drink using the “available” check boxes **(A)**. Disabled drinks will not be available for selection to the end customers.
- Select the language **(B)**.
- View the quick manual **(C)**.

**1** Click on the ‘**COLD DRINKS**’ Tab **(D)** to proceed with additional settings.

**2** Click on ‘**Done**’ to exit the Settings area **(E)**.



## 5.3 COLD DRINKS

On this screen you can:

- Select the dispensing option Glass OR Jug **(A)**;
- Set up the cup and jug portion size **(B)**;

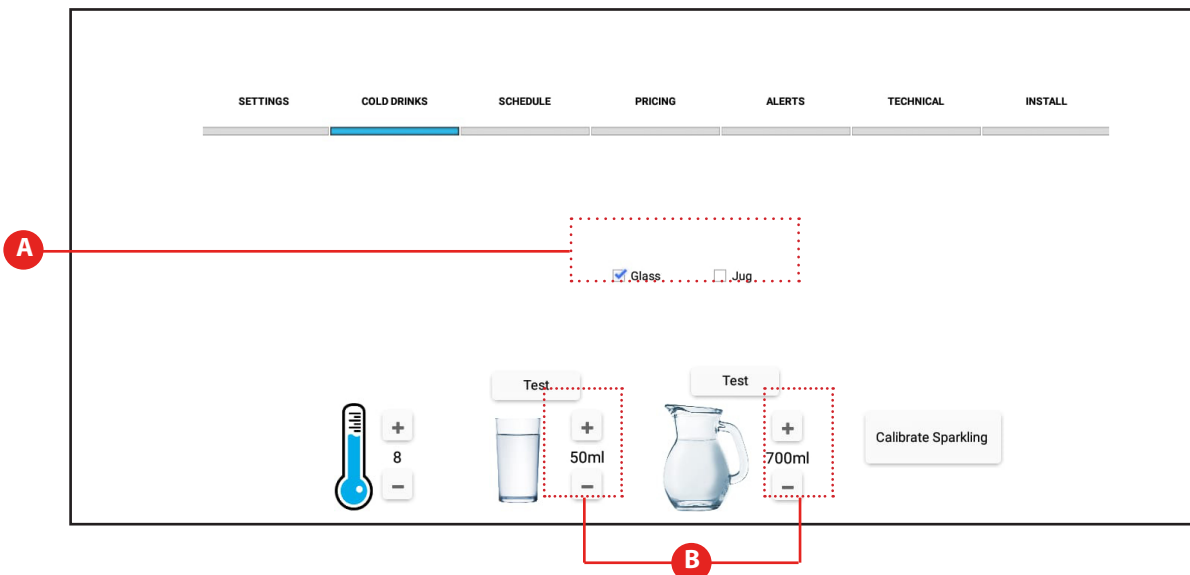



## Selecting drink dispensing option

Choose Glass OR Jug to select the preferred serving size **(A)**.

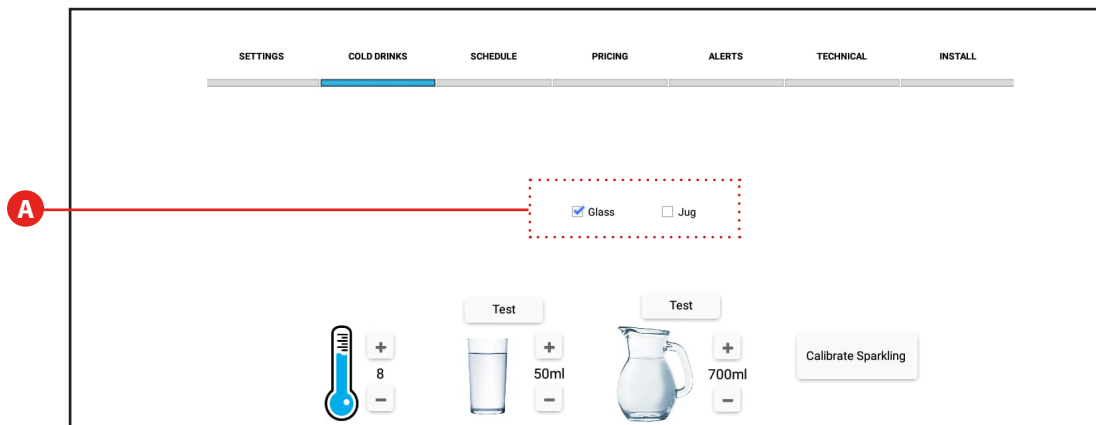

## Setting automatic dispensing portion size

Change dispensing portion size in **ml** for the glass and jug/carafe options using the + and - buttons **(B)**:

- Place a cup or jug in the dispensing area;
- Touch the 'Test' button **(C)** to dispense a sample;
- Calibration of the water portions can be performed using the 'Calibrate' button **(D)**.  
**This task should be performed only after purging the CO<sub>2</sub> water circuit.**

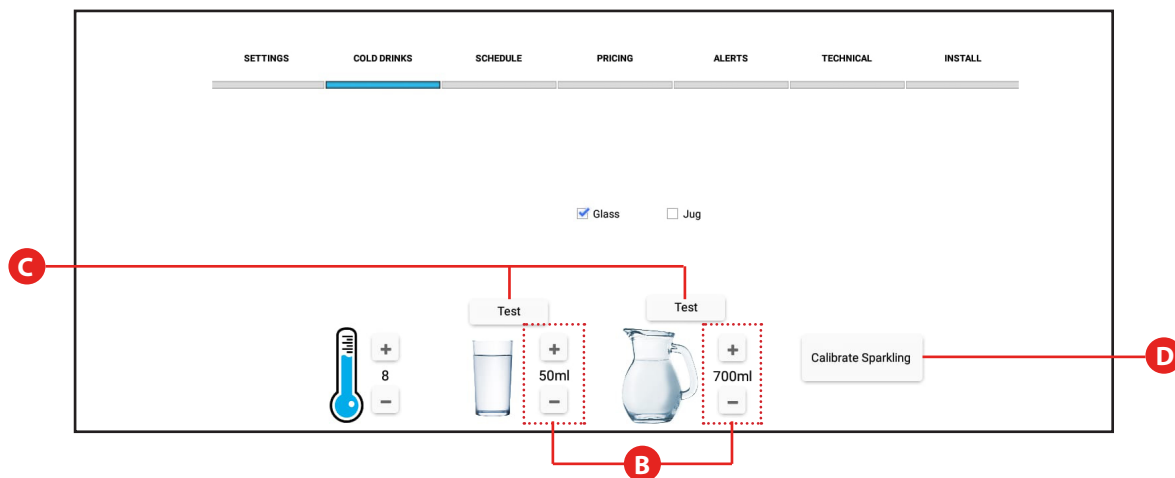

 **Note:** The unit has a dispensing accuracy >95% on all lines. Sparkling water dispensing dose is strongly modified by CO<sub>2</sub> bubbles.

To calibrate the dosage use the buttons **(B)** and and test for accuracy **(C)**.

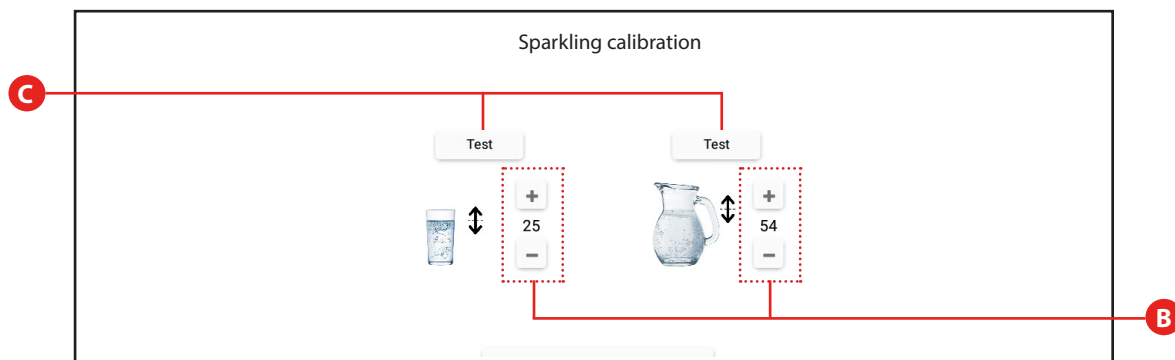

## 5.4 SCHEDULE



**Note:** This functionality can be enabled if the system is connected to the internet (4G SIM or Wi-Fi). All WEB features are available through a subscription plan. Our sales office is at your disposal for further information.

The unit has 3 **operating modes (A)** which can be set independently for each of the twelve 2-hour **slots** in the day (00:01-02:00, 02:01-04:00, etc) **(B)**:

- **Normal:** Normal operation mode, all drinks will be available for selection.
- **Chilled Water Only:** Out-of-hours operation mode, the machine will only dispense chilled still water.
- **Sleep - Energy Saving** Out-of-hours operation mode, all dispensing is suspended. The machine will operate in energy-saving mode. The current schedule can be displayed via the settings area.



**Note:** The day schedule can only be changed via the Zerica/BeviLaNatura web portal.

SETTINGS	COLD DRINKS	SCHEDULE	PRICING	ALERTS	TECHNICAL	INSTALL
		Advertising	Work Mode		Payment Mode	
<b>B</b>		00:00 - 01:59	low energy		Cash	<b>A</b>
		02:00 - 03:59	low energy		Cash	
		04:00 - 05:59	low energy		Cash	
		06:00 - 07:59	Normal		Cash	
		08:00 - 09:59	Normal		Cash	
		10:00 - 11:59	Normal		Cash	
		12:00 - 13:59	normal		Cash	
		14:00 - 15:59	normal		Cash	
		16:00 - 17:59	normal		Cash	
		18:00 - 19:59	normal		Cash	
		20:00 - 21:59	Normal		Cash	
		22:00 - 23:59	low energy		Cash	

## 5.5 PRICING



**Note:** This functionality can be enabled if the system is connected to the internet (4G SIM or Wi-Fi). All WEB features are available through a subscription plan. Our sales office is at your disposal for further information.

This section displays the set prices for each available drink.



**Note:** Prices can only be changed via the Zerica/BeviLaNatura web portal.

SETTINGS	COLD DRINKS	SCHEDULE	PRICING	ALERTS	TECHNICAL	INSTALL
			Regular		Large	
	Cold Drinks		€ 1.00		€ 1.10	
	Sparkling Water		€ 0.80		€ 1.00	
	Water		€ 0.50		€ 0.75	

## 5.6 ALERTS

The 'Alerts' tab displays a log of recently generated warnings / error messages.

Click on '**Refresh**' (A) to refresh the list.

Click on '**Clear**' (B) to clear the existing log.

SETTINGS	COLD DRINKS	SCHEDULE	PRICING	ALERTS	TECHNICAL	INSTALL
Fri Jan 17 2020 14:43:06	14:43:06	Error communicating with portal				
Fri Jan 17 2020 14:43:06	14:43:06	Error communicating with portal				
Fri Jan 17 2020 14:43:48	14:43:48	Not enough water in carbonator				
Fri Jan 17 2020 14:43:48	14:43:48	Main water pump protection stop				
Fri Jan 17 2020 14:44:03	14:44:03	Not enough water in carbonator				
Fri Jan 17 2020 14:44:03	14:44:03	Main water pump protection stop				
Fri Jan 17 2020 14:44:18	14:44:18	Not enough water in carbonator				
Fri Jan 17 2020 14:44:18	14:44:18	Main water pump protection stop				

Refresh Clear

### Warning triangle sign

A yellow triangle sign will appear on the top right corner of the screen every time there is a new warning message.

ERICA

Chilled Water Sparkling Water Water

## 5.7 TECHNICAL

On the left side of the screen you will be able to display a log of all information related to the machine including:

- Dispensed volumes by drink type;
- Current settings (portion size, dispensing option, etc);
- Running totals for filter and CO<sub>2</sub> canister;
- Key maintenance dates.

### Additional operations

On this screen you will be able to:

- A.** Flush the dispensing lines;
- B.** Purge the CO<sub>2</sub> circuit;
- C.** Reset CO<sub>2</sub> usage counter;
- D.** Reset Filter usage counters;
- E.** Reset service maintenance date;
- F.** Change screen brightness on specific times of the day.

 **Note:** Flush and CO<sub>2</sub> purge operations will be guided step-by-step on screen.

SETTINGS	COLD DRINKS	SCHEDULE	PRICING	ALERTS	TECHNICAL	INSTALL
Water Temp Cold	0			Mains Voltage	66	
Total Chilled Water	0			Compressor Amps	0	
Total Ambient Water	0			Compressor Watts	0	
Total Sparkling Water	0			Fan1 RPM	0	
Running Total Water	0			Fan2 RPM	0	
Filter Change Date	2020-01-22T12:59:03.962Z			PSU1 Volts	0	
Filter Life Days	180			PSU2 Volts	0	
Filter Life Litres	4000			Primary Pump Amps	0	
Filter Life Remaining Days	180			Juice System W	0	

Flush	Purge CO2	Replace CO2 Cannister	Replace Filter	Reset Service Date	Luminosità Schermo
-------	-----------	-----------------------	----------------	--------------------	--------------------

**A**   **B**   **C**   **D**   **E**   **F**

### **A. Flush**

Press this button when you want to perform the purge of the water lines using the step-by-step wizard.

### **B. CO<sub>2</sub> circuit purge**

Press this button when you want to carry out the procedure to purge the sparkling water line. This function is useful for example to remove any air present in the system, due to the reduction of mixing of CO<sub>2</sub> with water, and restore the right balance of CO<sub>2</sub> pressure inside the carbonator.

With perfectly purged water circuit and without air bubbles, the carbonator will reach full efficiency after about 24 hours of use.

 **Note:** Any presence of air left inside the carbonator will be removed during the delivery of sparkling water whose carbonation level will improve with the use of the product itself.

 **Note:** The presence of air inside the water circuit drastically reduces the mixing of carbon dioxide with water. This condition is highlighted by a whitish colour of the sparkling water supplied that should be always crystal and clear.

### C. Resetting the CO<sub>2</sub> usage counter

Every time a new CO<sub>2</sub> canister is connected to the machine it is necessary to reset the CO<sub>2</sub> usage counter using the 'Replace CO<sub>2</sub>' button. This function is useful, for example, for keeping track of CO<sub>2</sub> consumption.

 **Note:** The CO<sub>2</sub> consumption that is recorded represents only an indicative estimate.

 **Note:** The estimated number of liters of sparkling water based on the size of the CO<sub>2</sub> cylinder is pre-programmed on the machine. To change the pre-programmed values use the "Capacities" button on the 'Install' tab.

### D. Resetting the Filter usage counters

Use the 'Replace Filter' button every time you replace a filter cartridge to reset the usage counters (days since change and dispensed litres since change).

### E. Reset Service Date

It is recommended to carry out a general maintenance of the product every 6 months. Use the 'Reset Service Date' button to reset this counter.

### F. Screen Brightness

Use the "Screen Brightness" button to change the screen brightness level independently for each of the 12 daily slots of 2 hours each.

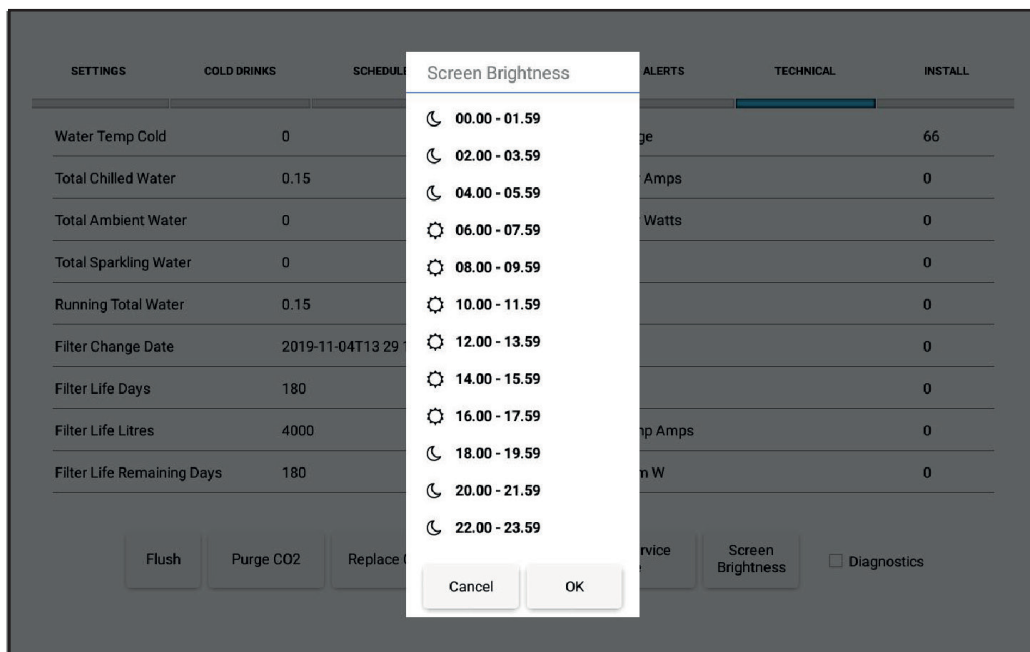

Click on the DAY  or NIGHT  icons to set the brightness of the display.

To confirm the settings, click OK.

To exit without confirming the parameters, click CANCEL.

## Usage log information

The following information is displayed on the left side of the Technical tab:

Variable	Description
<b>Water Temp Cold</b>	Current dispensing temperature for cold drinks. Please note, the machine will work to achieve the temperature indicated under the Cold Drinks settings
<b>Total Chilled</b>	Total chilled still water dispensed by the machine since start of operations
<b>Total Ambient</b>	Total ambient temperature water dispensed by the machine since start of operations
<b>Running Total Water</b>	Running total of dispensed amount since last filter change
<b>Filter Change Date</b>	Date of the last Filter replacement. Reset using the 'Replace Filter' button
<b>Filter Life Days</b>	Preset life span of the filter in days (default = 180 days)
<b>Filter Life Litres</b>	Preset life span of the filter in litres (default = 4000 litres)
<b>Filter Life Remaining Days</b>	Calculated based on dates. Warning when remaining 10% is reached
<b>Filter Life Remaining Litres</b>	Calculated based on usage. Warning when remaining 10% is reached
<b>CO<sub>2</sub> Running Total</b>	Total sparkling water dispensed in litres since the last CO <sub>2</sub> canister replacement. Reset using the 'Replace CO <sub>2</sub> ' button
<b>CO<sub>2</sub> Capacity Litres</b>	Preset number of litres of sparkling water achievable at average setting based on the standard canister size (600 g of CO <sub>2</sub> producing 75 litres of sparkling water)
<b>CO<sub>2</sub> Remaining Litres</b>	Calculated based on usage. Warning when remaining 10% is reached
<b>Machine ID</b>	Machine ID set-up at the factory and used to identify the machine on the web porta
<b>Machine Num</b>	Last part of the Machine ID
<b>Installation date</b>	Date of first launch of the tablet app
<b>Last Service Date</b>	Date of last major service. Reset using the 'Reset Service Date' button
<b>Service Interval Days</b>	Preset at 180 days
<b>Service Remaining days</b>	Calculated based on dates. Warning when remaining 10% is reached
<b>Last Data Sync</b>	Date and time of the last data exchange via the internet
<b>Last Restart</b>	Date and time of the last restart o the app
<b>Software Version</b>	Installed software version number
<b>Cup Size</b>	Current setting for cold drink's cup
<b>Jug Size</b>	Current setting for cold drink's jug
<b>CO<sub>2</sub> level</b>	Not currently used
<b>Enable still</b>	Enable/disable dispensing of still water
<b>Enable sparkling</b>	Enable/disable dispensing of sparkling water
<b>Enable Manual</b>	Enable/disable manual dispensing (the 'hand' control for the end user)
<b>Enable Cup / Jug</b>	Enable/disable portion control for cold drinks for the two drink sizes



## 5.8 INSTALL



On this screen you will be able to:

- A. Display configuration parameters for the unit.
- B. Enable or disable remote diagnostics for the unit.



**Note:** By enabling this function it will be possible to collect technical data (e.g. dispensed volumes) and parameters from the unit. The information will be accessible from the ZERICA PORTAL on the web (the system must be connected to the internet via SIM or WIFI). All WEB features are available through a subscription plan. Please contact the sales office for more information.

- C. Perform a factory reset of the machine ('Factory Reset' button).
- D. Set the life parameters for the filter (days, dispensed volume) based on your filter of choice. Set the expected volume of sparkling water from one canister of CO<sub>2</sub> based on your canister size. ('Capacities' button).
- E. Exit the app completely pressing the 'Quit' button.
- F. Setting up a wi-Fi connection ('Wi-Fi' icon).

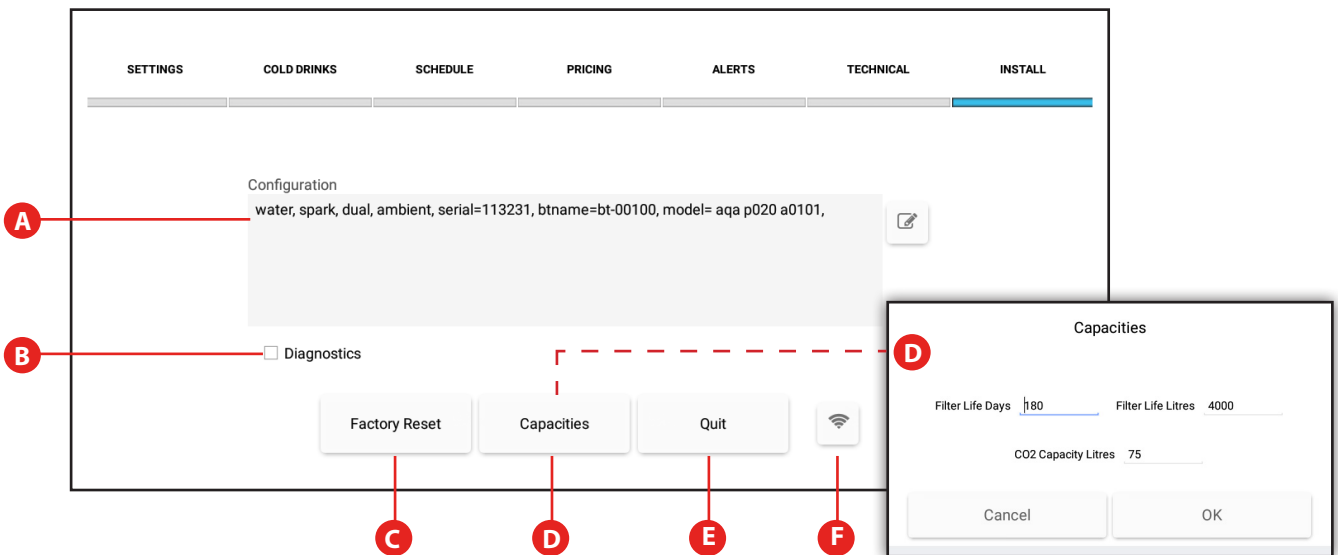

## 5.9 EXITING THE SETTINGS AREA

To exit the settings area, press the 'Done' button on the 'Settings' tab.

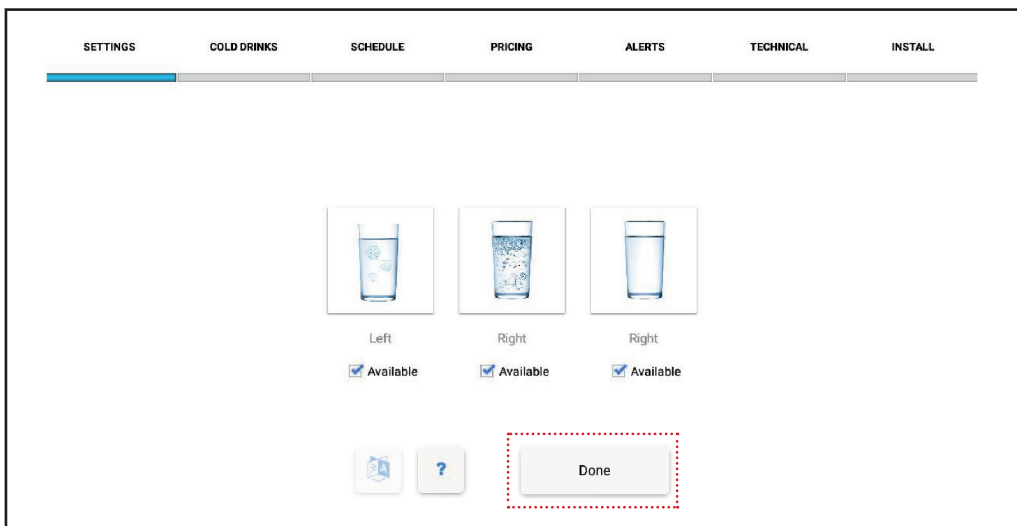

# 6. MAINTENANCE

Our products have been designed to offer maximum hygiene and ease of maintenance. They are robust and with high performance.

In order to keep the product in full efficiency, we recommend a periodic check and in any case at least every 6 months, of all the components.

We recommend an internal cleaning of the water lines in the following cases:

- first installation (dispense a few liters for at least a couple of minutes);
- replacement of components in contact with water;
- suspected pollution or bacterial infection (bad smell / taste or turbidity of the water);
- re-installation in a different location or after a break down;
- unit switched off for at least 5 days.



The machine will display a “Service due” warning message every 180 days. To reset the service date, use the “Reset Service Date” button on the “Technical” tab.



**Note:** When you have performed a maintenance service or filter replacement do not forget to reset the counters using the relevant buttons on the “Technical” tab (Touch model only).

It is advisable to keep a record of all maintenance interventions on a dedicated register. On the following pages you will find an example.

## 6.1 MAIN MAINTENANCE TASKS

The following table shows the suggested maintenance tasks and their recommended frequency.

Task	Frequency (days)	Description
Cleaning of the drip tray	1	Empty and clean the drip tray at least once a day. Use non-toxic cleaning products, suitable for stainless steel / plastic components.
Flush of the water lines	28	Access the settings area. Press on the “Technical” tab; place an empty carafe with a capacity of at least 1 liter on the surface; press the “Flush” button and follow the instructions on screen.
Filter replacement	variable*	Replace filter and reset counter using button on the “Technical” tab
CO <sub>2</sub> canister replacement		Replace canister and reset counters using button on the “Technical” tab
Internal components check	90	Visual inspection of internal components for leaks. Dispensing test to check correct operation of the unit.

\*based on equipment and dispensed volumes



## 6.2 ON-SCREEN MONITORING AND WARNING MESSAGES (TOUCH MODEL ONLY)

### Warning triangle sign

A yellow triangle sign will appear on the top right corner of the screen every time there is a new warning message.



Touch the ZERICA logo (A) to read the warning messages in the text box (B).  
With the same action it is possible to access the monitoring area.

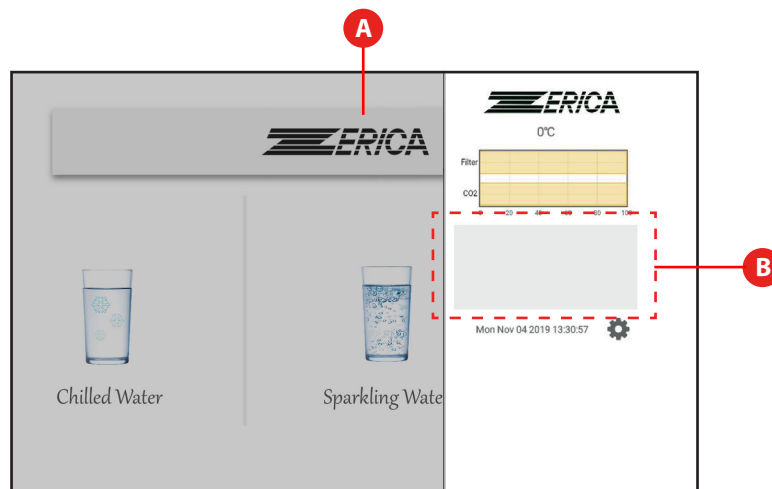

## Key warning messages

Message	Description	Action required
<b>Machine not found</b>	Communication between the tablet and the machine is interrupted	First try to switch off and then back on again the machine. If connection is not re-established with two minutes, access the bluetooth settings of the app and re-establish connection. If this fails to fix the problem, re-boot the tablet and restart the BeviLaNatura/ Zerica app. Wait at least two minutes from restart before trying dispensing again
<b>Wi-Fi connection interrupted</b>	Communication between the machine and the local wi-fi network is interrupted	Check your wi-fi status. Access the wi-fi settings of the app and re-establish connection
<b>CO<sub>2</sub> running low</b>	The estimated remaining content of CO <sub>2</sub> is less than 10%	You will soon need to replace the CO <sub>2</sub> canister
<b>Filter needs replacing</b>	The water filter needs replacing (according to the manufacturer's recommendation) - less than 10% useful life remaining	Replace the water filter
<b>Flush due</b>	The machine is pre-set to request a Flush every 28 days	Perform flush using the 'Flush' button on the Technical tab
<b>Service due</b>	A major maintenance service is due. The machine is pre-set to request a Flush every 180 days	Contact your technical support
<b>other technical messages...</b>	The screen will display other types of messages in case of technical malfunctioning of the machine	Contact your technical support

# MAINTENANCE RECORD (EXAMPLE)

<b>Install date</b>	<b>Client</b>	
<b>Address</b>	<b>Phone number</b>	<b>Installer details</b>
<b>Model</b>		<b>Serial number</b>

**Respect the maintenance dates during the warranty period**  
(see warranty clauses)

<b>Date</b>	<b>Dispensed litres counter</b>	<b>Parts replaced</b>	<b>Service performed by</b>

# 7.

## DEMOLITION AND DISMANTLING

The user has the obligation to dispose of the device at the end of its life cycle in compliance with the current regulations and in particular the requirements of the WEEE directives regarding the disposal of equipment and machines.



This symbol on the product or in the instructions means that your electrical and electronic equipment should be disposed at the end of life separately from household waste. There are separate collection centres for recycling across the EU.

For more information, please contact the local authority or the retailer you purchased the product from.



Zerica® aderisce al Consorzio **ECOEM**  
Registro Produttori AEE n° **IT19090000011663**

# 8.

## WARRANTY

ZERICA® guarantees that its products does not have any material, design or manufacture defects.

The warranty is valid when product is properly operating under normal conditions of use in accordance with technical manuals and ZERICA® specifications and for a period of 12 months from the date of purchase (invoice date will be used as reference).

The warranty does not cover the replacement of parts due to normal wear and tear, consumable parts, related replacement parts or any abuse or misuse, including but not solely limited to the failure to use this product for its normal purposes or in accordance with ZERICA®'s instructions on usage and maintenance.

The warranty is limited to the replacement or repair of faulty parts at ZERICA®'s factory and it does not cover in no event the entire replacement of the faulty product or the reimbursement of costs incurred by the reseller for any intervention.

All products being returned for repair and faulty parts shall be shipped to ZERICA® with freight prepaid after requesting the return authorization by means of the appropriate RMA request form.

ZERICA® will return the repaired product or send the spare parts with transportation charges prepaid.

ZERICA®, REFRESH® and HPDC® are registered trade marks of ZERICA® srl Italia, which reserves the right to make any changes without notice.

The technical performance values shown on product literature may vary depending on the environment and use of the product.

# WARRANTY



1

Unit registered to:

Name and Surname

Address

Post code

City

Country

Model

Retailer / Installer details and stamp	Serial Number
Purchase date	

# WARRANTY



2

Unit registered to:

\_\_\_\_\_  
Name and Surname

\_\_\_\_\_  
Address

\_\_\_\_\_  
Post code

\_\_\_\_\_  
City

\_\_\_\_\_  
Country

\_\_\_\_\_  
Model

Retailer / Installer details and stamp	Serial Number
Purchase date	



# 9. EC DECLARATION OF CONFORMITY

Manufacturer: **ZERICA® s.r.l.**

Address: Zona Industriale – 90018 Termini Imerese (PA)

Declares under its responsibility that this product:

- **Complies with the requirements of EEC Directive (2006/95/EC) - low tension directive**
- **Complies with the requirements of EEC Directive (2004/108/EC - EMC) – electromagnetic compatibility:**

Electrical safety:

**CEI EN 60335-1 :2013-01**

Safety of electrical appliances for household and similar use. Part 1: General requirements.

**CEI EN 60335-2-89/2011**

Electrical appliances for household and similar purposes - Safety. Part 2: Particular requirements for appliances for commercial refrigeration condensing unit of refrigerant, compressor or an incorporated or remote.

Electromagnetic compatibility:

**CEI EN 55014-1/2008+A1-2010+A2-2012**

Electromagnetic compatibility. Requirements for household appliances, electric tools and similar apparatus.

Part 1: Emission

**CEI EN 55014-2/1998+A1-2002+IS1-2007+A2-2009**

Electromagnetic compatibility. Requirements for household appliances, electric tools and similar apparatus.

Part 2: Immunity

**CEI EN 61000-3-2/2007+A1+A2-2011 Part 3-2:**

Electromagnetic compatibility. Part 3: Limits - Section 2: Limits for harmonic current emissions (equipment input current less than 16A per phase).

**CEI EN 61000-3-3/2014**

Electromagnetic compatibility. Part 3: Limits - Section 3: Limitation of voltage fluctuations and flicker in low-voltage supply systems for equipment with rated current less than 16A and not subject to conditional connection.

Zerica® declares under its responsibility that this product:

- **Complies with Directive 2011/65/CE (RoHS 2)-“Restricting the use of certain hazardous substances in electrical and electronic equipment” - RoHS.**
- **The carbonators used by ZERICA® S.r.l. have been designed and produced according to sound engineering practice, tested according to the reference procedures and are suitable for use in systems for producing sparkling water, using only drinking water and CO2 at a maximum operating pressure of 7 bar.**
- **The carbonators are inserted in systems subject to the Machinery Directive (89/392/EC) or the Low Voltage Directive (73/23/EC) and therefore do not fall within the scope of the Pressure Equipment Directive - PED (97/23/EC) according to the exclusions in art. 1 point 3.6. of said Directive.**
- **In addition, the models of carbonators used by Zerica have a product PSxV below the limit established by the PED, at 50, and do not therefore have to be CE-marked as they come under the equipment referred to in art. 3§3 in said directive.**



# 10.

## DECLARATION DM 174/2004

Zerica® has also requested verification of conformity assessment pursuant to the Italian Decree of 6 April 2004 no. 174 in appliance to REGULATION (EEC) N. 1935/2004 - "materials that come into contact with the water destined for human consumption" via the following tests:

Report issued on 11th May 2009 by G.R. Biochemilab, Modena, Italy

Report issued on 10th December 2010 by Bioanalisi, Erice, Italy

Report issued on 6th April 2018 by Bioanalisi, Erice, Italy

Based on the outcomes of the reports, Zerica states the conformity of the appliance to the Decree of April 06, 2004 no.174.





**ZERICA® srl**  
**Zona Industriale**  
**90018 Termini Imerese (Pa) - Italy**  
**Tel. +39.091.8140341 - Fax +39.091.8140364**  
**[www.zerica.com](http://www.zerica.com) e-mail: [info@zerica.com](mailto:info@zerica.com)**

Total or partial reproduction is forbidden. The manufacturer declines any responsibility for any typographical errors included in this manual. Zerica reserves the right to make amendments to its own products considered necessary or useful without jeopardising their functional features, without prior notice.